

RENOVATIONS AT 25 LINDEN STREET BROOKLINE MA

NORDESIGN & BUILD ARCHITECTS
21 HOUGH ROAD BELMONT MA 02478 617-293-5299

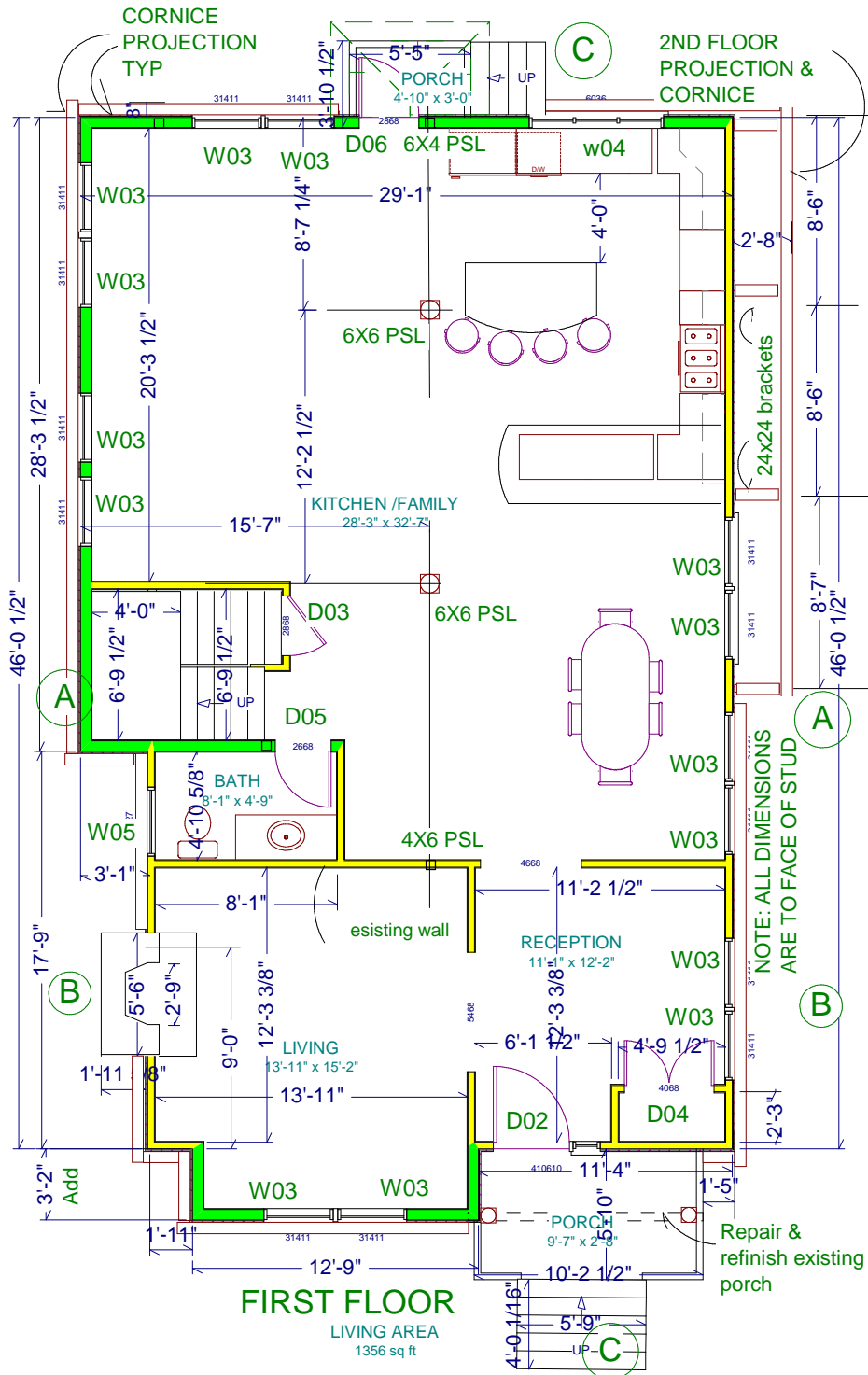

NOTE: ALL DIMENSIONNS ARE TOTHE FACE OF FRAMING

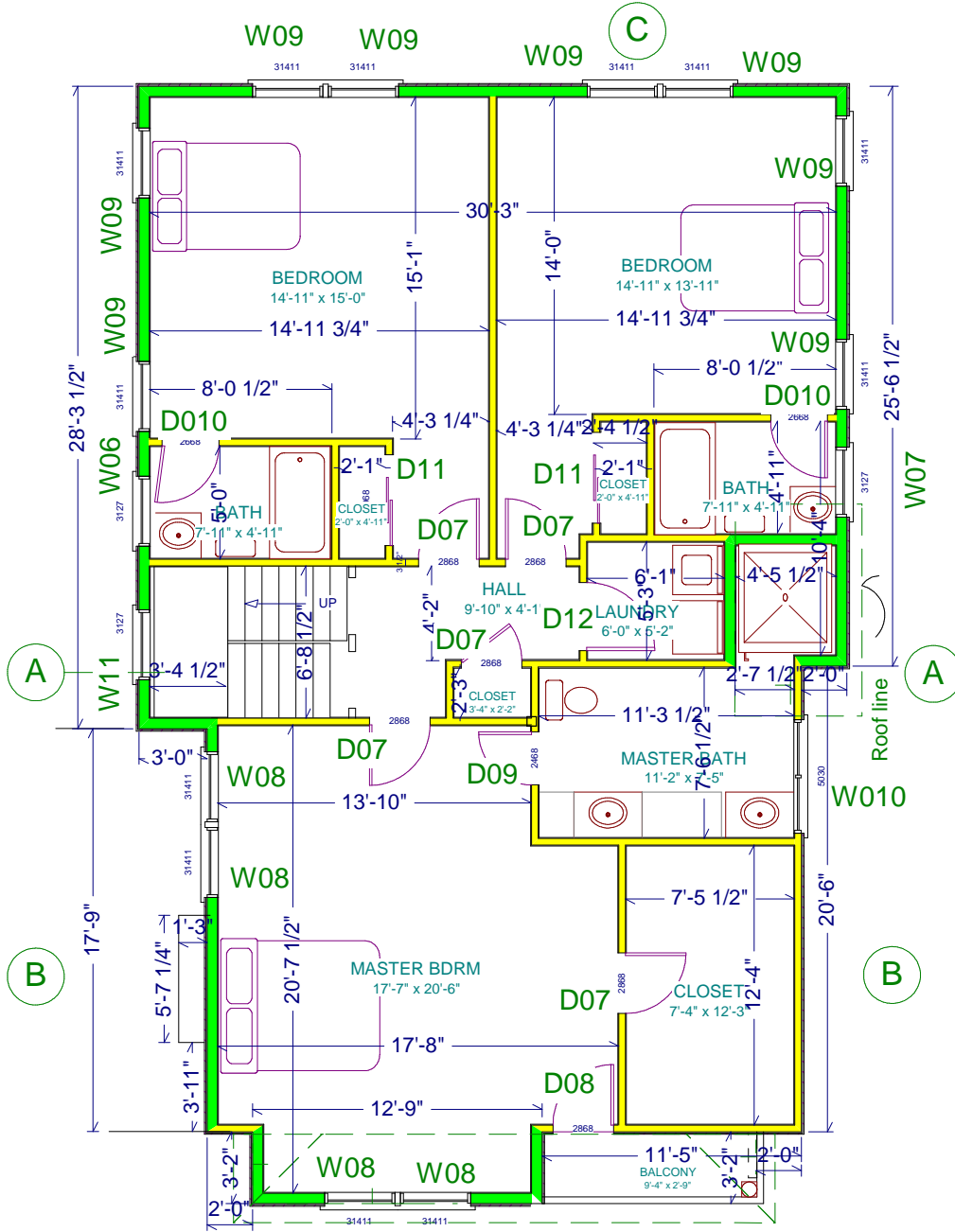

SECOND FLOOR

LIVING AREA
1380 sq ft



All new exterior walls are in 2x6@16" framing.

RENOVATIONS AT 25 LINDEN STREET BROOKLINE MA

NORDESIGN & BUILD ARCHITECTS
21 HOUGH ROAD BELMONT MA 02478 617-293-5299

